

VERTICAL SUPPORT 90°

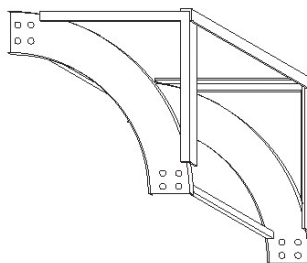
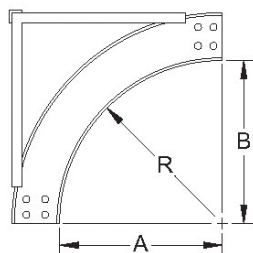

To complete catalogue number insert the appropriate prefixes (2) in place of asterisks.

V	S	A	—	*	9	6	**
↓	↓	↓		↓	↓	↓	↓
BASIC PART		MATERIAL FINISH		SIDERAIL HEIGHT	RADIUS	WIDTH	RUNG SPACING
VS - Vertical Support		A - Aluminum		1 - C / 90mm (3.5") 2 - C / 152mm (6.0") 4 - D / 114mm (4.5") 5 - D / 152mm (6.0") 7 - E / 114mm (4.5") 8 - E / 152mm (6.0") H - E / 160mm (6.3") 9 - E / 203mm (8.0")	3 - 305mm (12") 6 - 610mm (24") 9 - 915mm (36") * - 1220mm (48")	2 - 150mm (6")† 3 - 203mm (8") 5 - 300mm (12") 6 - 450mm (18") 7 - 600mm (24") 8 - 750mm (30") 9 - 900mm (36")	1 - Solid 2 - Ventilated 4 - Ladder

† - Not available in 9 series.

BEND RADIUS		TRAY WIDTH		CATALOGUE #	DIMENSIONS mm (in)			
R		W			A		B	
mm	(in)	mm	(in)	* SIDERAIL HEIGHT ** RUNG SPACING	mm	(in)	mm	(in)
305mm	(12")	150	(6)	VSA-(*)32(**)	305mm	(12")	305mm	(12")
		203	(8)	VSA-(*)33(**)				
		300	(12)	VSA-(*)35(**)				
		450	(18)	VSA-(*)36(**)				
		600	(24)	VSA-(*)37(**)				
		750	(30)	VSA-(*)38(**)				
		900	(36)	VSA-(*)39(**)				
610mm	(24")	150	(6)	VSA-(*)62(**)	610mm	(24")	610mm	(24")
		203	(8)	VSA-(*)63(**)				
		300	(12)	VSA-(*)65(**)				
		450	(18)	VSA-(*)66(**)				
		600	(24)	VSA-(*)67(**)				
		750	(30)	VSA-(*)68(**)				
		900	(36)	VSA-(*)69(**)				
915mm	(36")	150	(6)	VSA-(*)92(**)	915mm	(36")	915mm	(36")
		203	(8)	VSA-(*)93(**)				
		300	(12)	VSA-(*)95(**)				
		450	(18)	VSA-(*)96(**)				
		600	(24)	VSA-(*)97(**)				
		750	(30)	VSA-(*)98(**)				
		900	(36)	VSA-(*)99(**)				
1220mm	(48")	150	(6)	VSA-(*)2(**)	1220mm	(48")	1220mm	(48")
		203	(8)	VSA-(*)3(**)				
		300	(12)	VSA-(*)5(**)				
		450	(18)	VSA-(*)6(**)				
		600	(24)	VSA-(*)7(**)				
		750	(30)	VSA-(*)8(**)				
		900	(36)	VSA-(*)9(**)				